



U.S. BASED SUPPORT

HOURS: MONDAY - FRIDAY | 8AM - 5PM EST



[1.410.840.3555](tel:1.410.840.3555)



support@iagperformance.com





IAG Front Splitter For 2015-2021 WRX/STI

IAG Front Splitter for 2015-2021 WRX/STI

Part Number: IAG-BDY-5341

Congratulations on the purchase of your IAG Splitter, and thank you for choosing IAG Performance! These instructions are intended for users with basic mechanical skills. Professional installation is not required.

Product includes:

1 Splitter

2 (X2) Winglets

3 (X2) Brackets

**4 Rivet-Nut
installation tool**

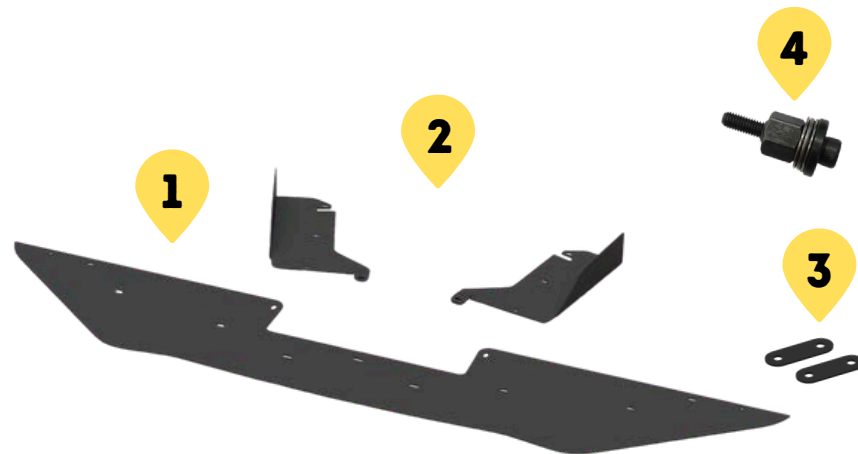

Tools Needed:

4mm and 5mm Allen wrench
12mm wrench or socket
14mm Wrench
Push Clip Pliers
Tape Measure or Caliper

Hardware:

Rivet-Nut
(M6)



X13

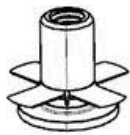

Oversized
Washer



X13



M6 Bolt
40mm long



X7



M6 Bolt
30mm long



X6



M8 Bolt
65mm Long



X2



Washer
M6



X13



Washer
M8



X2

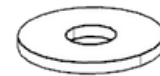

M6 Spacer
3mm



X4



M6 Spacer
5mm



X4



M6 Spacer
10mm



X2

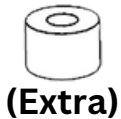

M6 Spacer
15mm



X2



M6 Spacer
20mm



X3

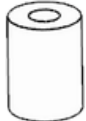

M8 Spacer
5mm



X2



M8 Spacer
35mm



X2



M6 Lock
Washer



X4



M6 Bolt
6mm Long



X4



Part 1: Insert Riv-Nuts

Step 1:

Remove the factory push clips from the circled locations pictured below.
Remove the two factory 12mm bolts from the splash shield.

Step 2:

Use provided Rivet-Nut installation tool to install the Rivet-Nuts.
Thread the Rivet onto the tool, and insert Rivet into the circled locations.
Place an oversized washer over the rivet to increase rigidity.
Using 14mm wrench hold the tool stationary, then tighten 5mm Allen bolt until snug.
Remove tool from rivet.
Solid circles represent rivets mounted directly into bumper, dashed circles are rivets inserted behind bumper.

Part Description	Quantity
A M6 Rivet-Nut	13
B Oversized Washers	13

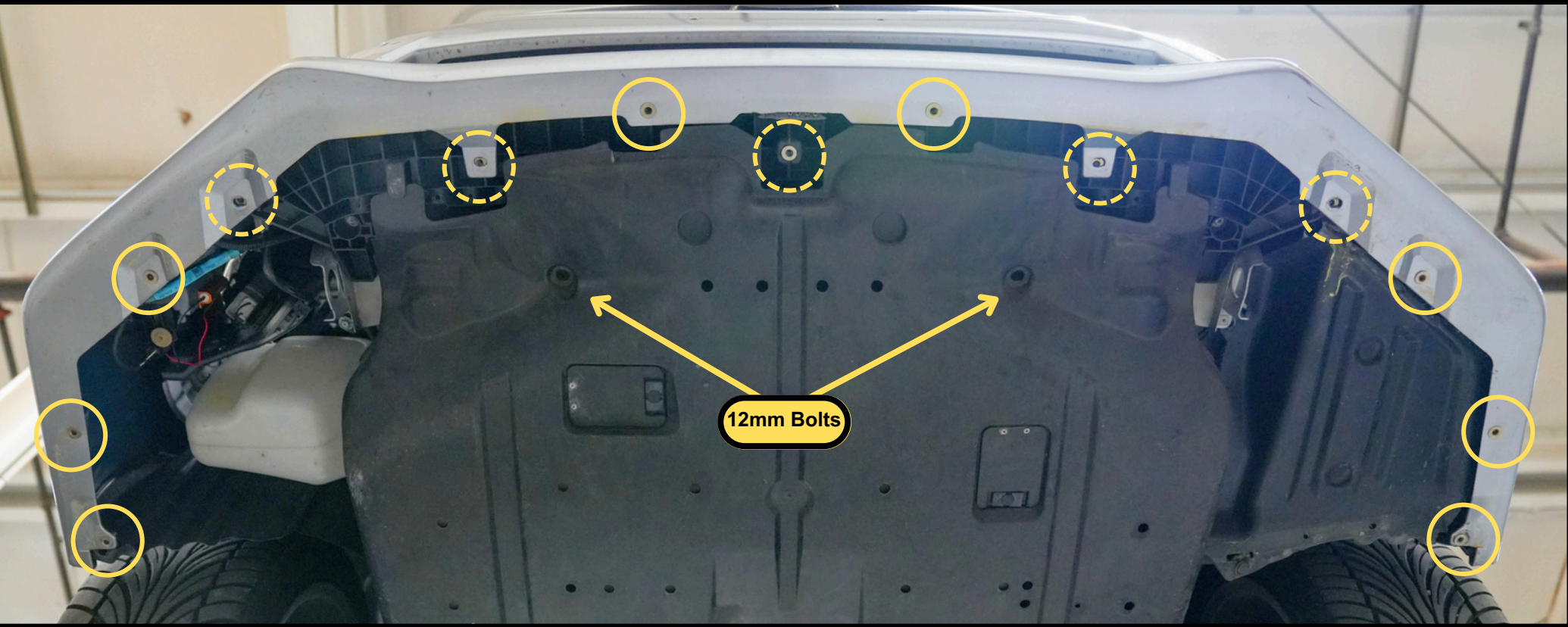
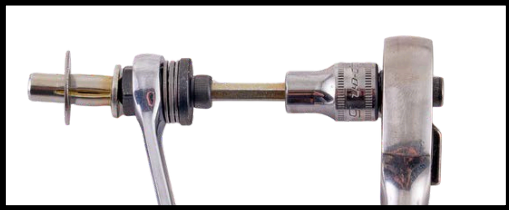

Part 2: Assemble the Front Splitter

Step 3:

Hold the splitter up to the front bumper with the help of a friend, or by using jack stands/wood to support the splitter.

Step 4:

Using the diagram below, assemble the spacers into the appropriate locations.

Using a 5mm Allen wrench, install M8 Bolts with washers and tighten. (20Nm)

Using a 4mm Allen wrench, install M6 Bolts with washers and tighten. (8Nm)

Extra spacers have been included in the kit to fine tune fitment.

Recommend using provided Loctite on fasteners.

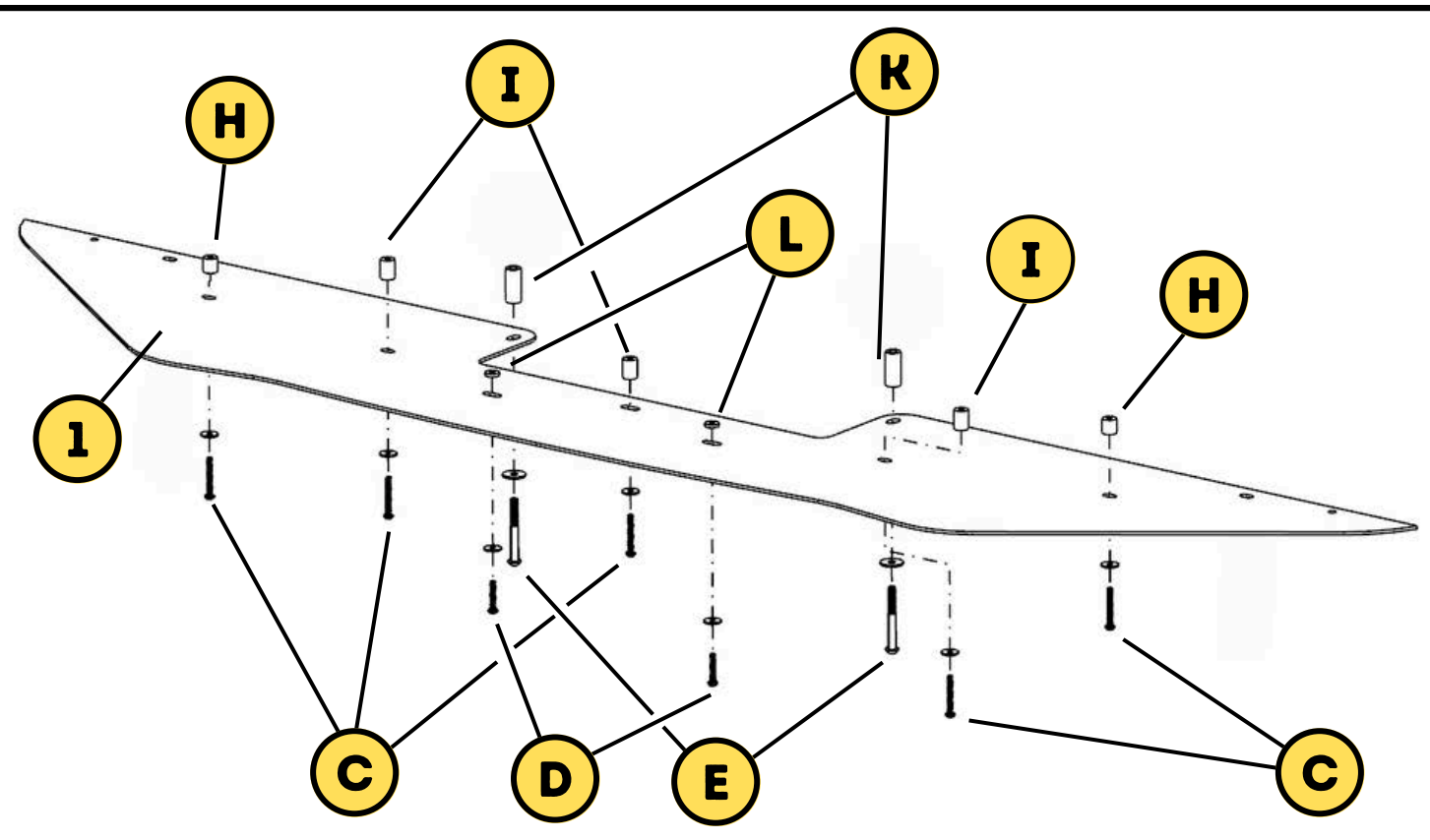

Part Description	Quantity
1 Front Splitter	1
C M6 Bolt 40mm Long	5
D M6 Bolt 30mm Long	2
E M8 Bolt 65mm Long	2
F M6 Washer	7
G M8 Washer	2
H 15mm Spacer (M6)	2
I 20mm Spacer (M6)	3
K 35mm Spacer (M8)	2
L 3mm Spacer (M6)	2

Part 3: Assemble Winglets

Step 5:

Assemble the Left Winglet onto the vehicle.

Step 6:

Using the diagram below, assemble the spacer into the appropriate location.

Using a 4mm Allen wrench, install M6 Bolts with washers and tighten. (8Nm)

Install the M6 bolts for the Bridge Bracket with lock washers only. (10Nm)

Repeat for other side.

Step 7:

Install provided Edge Guard and Sticker if desired.

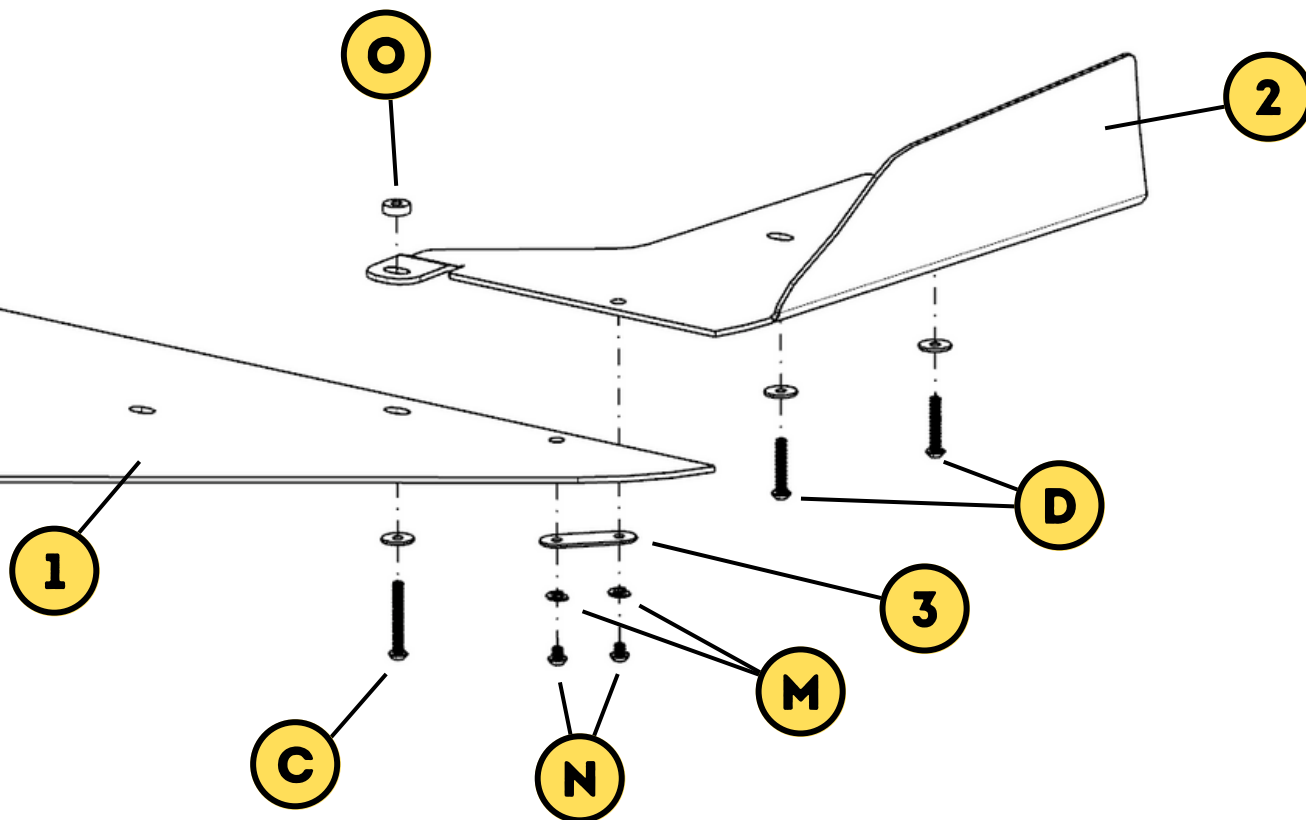

Part Description	Quantity
2 Winglet	2
3 Bridge Bracket	2
C M6 Bolt 40mm Long	2
D M6 Bolt 30mm Long	4
F M6 Washer	6
M Lock Washer	4
N M6 Bolt 6mm Long	4
O 5mm Spacer (M6)	2



If you have any questions about
the installation or product
please contact
support@iagperformance.com
or call 410-840-3555